



SPARE PARTS LIST

CULTIVATORS/TILLERS

MFT 85-160R, 966649601, 2014-12

REPAIR PARTS

TILLER - MODEL NO. MFT55 170R / MFT60 120R / MFT85 160R / MFT85 700R / MFT85 900R , PRODUCT NO. 577 49 01-01

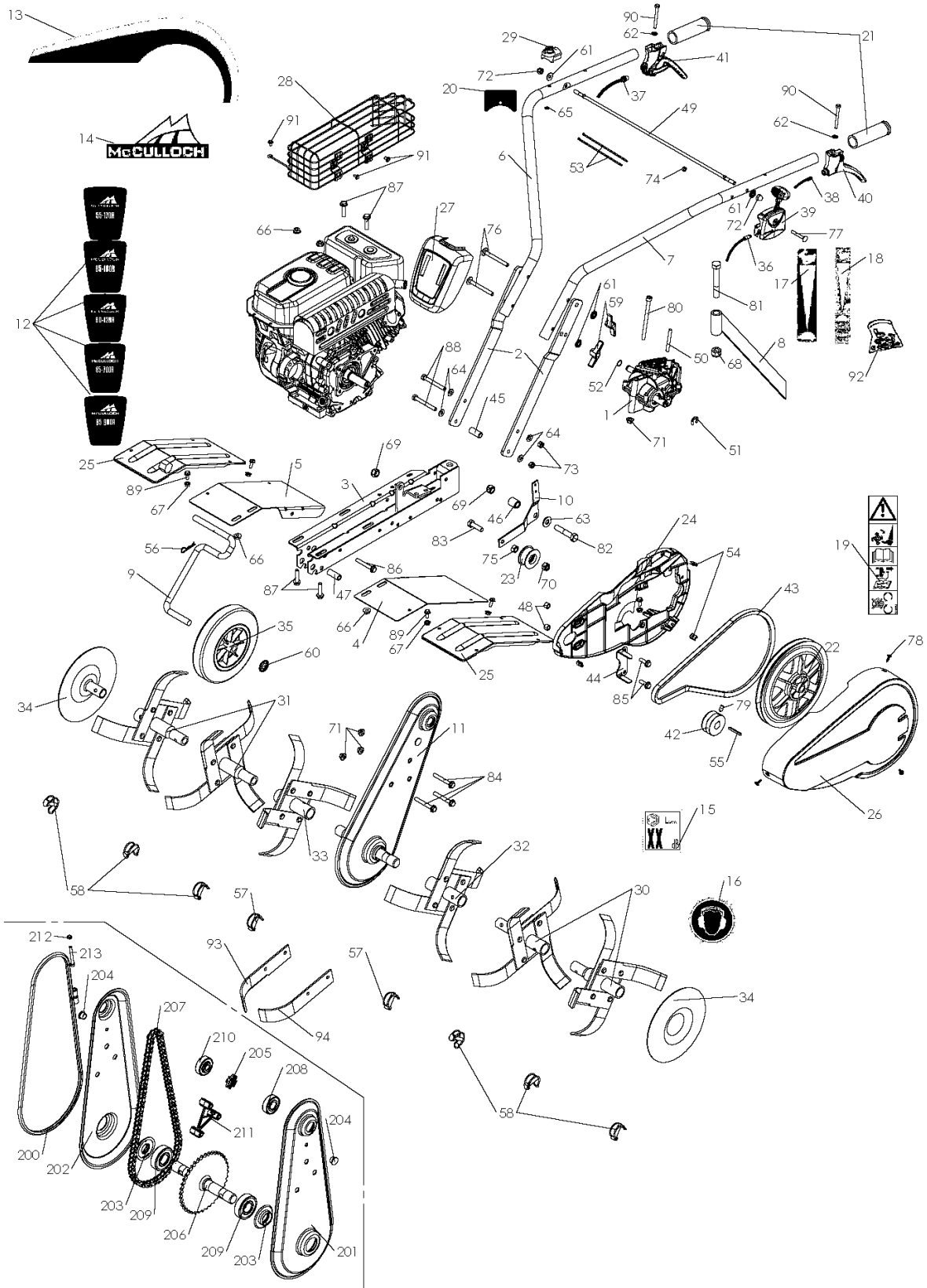

PRODUCT COMPLETE

MFT 85-160R, 966649601, 2014-12

| Ref | Part No | Description | Remark | QTY KIT |
|-----|--------------|---------------------|---------------------------|---------|
| 1 | 588 42 12-01 | GEAR BOX | | 1 |
| 2 | 577 48 75-01 | HANDLEBAR | | 2 |
| 3 | 577 48 74-01 | FRAME | | 1 |
| 4 | 577 48 79-01 | GUARD | | 1 |
| 5 | 577 48 78-01 | GUARD | | 1 |
| 6 | 577 48 77-01 | HANDLEBAR | | 1 |
| 7 | 577 48 76-01 | HANDLEBAR | | 1 |
| 8 | 531 00 82-06 | TAIL-SKID | | 1 |
| 9 | 577 44 80-01 | WHEEL | | 1 |
| 10 | 519 65 34-07 | LEVER | | 1 |
| 11 | 575 35 87-01 | TRANSMISSION | | 1 |
| 12 | 585 36 51-01 | STICKER | | 1 |
| 12 | 586 66 28-01 | STICKER | | 1 |
| 12 | 577 48 95-01 | STICKER | | 1 |
| 12 | 577 48 96-01 | STICKER | | 1 |
| 12 | 577 48 97-01 | STICKER | | 1 |
| 13 | 577 48 94-01 | STICKER | | 1 |
| 14 | 577 48 93-01 | STICKER | | 1 |
| 15 | 587 69 99-01 | LABEL | LC170/GX160/750 SERIES | 1 |
| 15 | 501 96 25-01 | LABEL | GX120/950 SERIES | 1 |
| 16 | 577 46 33-01 | STICKER | | 1 |
| 17 | 519 64 66-80 | DECAL | 750 SERIES/950 SERIES | 1 |
| 18 | 531 00 82-51 | DECAL | LC170/GX | 1 |
| 19 | 531 00 85-40 | DECAL | | 1 |
| 20 | 501 96 37-01 | LABEL | LC170/GX | 1 |
| 21 | 544 31 14-01 | GRIP | | 2 |
| 22 | 519 65 30-60 | PULLEY | | 1 |
| 23 | 519 65 34-57 | PULLEY | | 1 |
| 24 | 577 52 48-01 | COVER PLATE | | 1 |
| 25 | 577 48 85-01 | GUARD | | 2 |
| 26 | 577 48 87-01 | BELT COVER | | 1 |
| 27 | 577 48 90-01 | BRACKET | | 1 |
| 28 | 577 54 63-01 | GRILLE | LC170 | 1 |
| 28 | 531 00 94-18 | GRILL | GX | 1 |
| 29 | 577 51 77-01 | SWITCH | LC170 | 1 |
| 29 | 531 00 85-58 | STOP SWITCH | GX | 1 |
| 30 | 531 00 82-14 | TINE | | 2 |
| 31 | 531 00 82-15 | TINE | | 2 |
| 32 | 531 00 82-11 | BLADE | | 1 |
| 33 | 531 00 82-13 | BLADE | | 1 |
| 34 | 519 65 33-62 | COVER | | 2 |
| 35 | 577 44 78-01 | WHEEL | | 1 |
| 36 | 577 52 50-01 | THROTTLE CABLE | | 1 |
| 37 | 577 46 37-01 | CABLE | | 1 |
| 38 | 588 42 13-01 | CABLE | | 1 |
| 39 | 577 45 30-01 | THROTTLE LEVER | | 1 |
| 40 | 501 00 52-01 | GEAR SHIFT LEVER | | 1 |
| 41 | 577 46 36-01 | LEVER | | 1 |
| 42 | 544 24 39-01 | PULLEY | | 1 |
| 43 | 575 36 02-01 | BELT | | 1 |
| 44 | 531 00 85-77 | BELT GUIDE | | 1 |
| 45 | 575 36 09-01 | SPACER | | 1 |
| 46 | 575 36 05-01 | SPACER | | 1 |
| 47 | 575 36 10-01 | SPACER | | 1 |
| 48 | 531 00 82-16 | SPACER | | 2 |
| 49 | 577 45 24-01 | HANDLEBAR | | 1 |
| 50 | 519 65 30-67 | SHAFT | | 1 |
| 51 | 580 31 42-01 | RETAINER RING | | 1 |
| 52 | 519 65 34-66 | RETAINING RING | | 1 |
| 53 | 544 31 11-01 | COLLAR | | 4 |
| 54 | 519 65 34-25 | CLIP | | 3 |
| 55 | 519 65 30-21 | KEY | | 1 |
| 56 | 519 65 12-20 | PIN RETAINING SCREW | | 1 |
| 57 | 577 45 36-01 | CLIP | | 2 |

PRODUCT COMPLETE

MFT 85-160R, 966649601, 2014-12

| Ref | Part No | Description | Remark | QTY KIT |
|-----|--------------|---------------------|------------------|---------|
| 58 | 577 45 35-01 | CLIP | | 6 |
| 59 | 531 00 84-62 | WING NUT | | 2 |
| 60 | 577 46 31-01 | WASHER | | 1 |
| 61 | 544 31 49-01 | WASHER | | 4 |
| 62 | 531 00 94-03 | WASHER | | 2 |
| 63 | 519 65 34-53 | WASHER | | 1 |
| 64 | 544 20 81-01 | WASHER | | 4 |
| 65 | 531 00 85-39 | WASHER | | 1 |
| 66 | 519 65 34-30 | NUT | | 4 |
| 67 | 519 65 34-32 | NUT | | 5 |
| 68 | 531 00 85-78 | NUT | | 1 |
| 69 | 752 25 50-51 | ECROU DE FREIN | | 2 |
| 70 | 519 65 34-58 | NUT | | 1 |
| 71 | 586 72 10-01 | NUT | | 5 |
| 72 | 577 48 91-01 | CAP NUT | | 2 |
| 73 | 544 20 79-01 | NUT | | 2 |
| 74 | 732 26 16-01 | HEXAGON LOCKING NUT | | 1 |
| 75 | 519 65 34-56 | NUT | | 1 |
| 76 | 575 36 13-01 | SCREW | | 2 |
| 77 | 577 45 38-01 | SCREW | | 1 |
| 78 | 519 65 34-26 | SCREW | | 3 |
| 79 | 728 69 23-00 | SCREW | | 1 |
| 80 | 577 52 53-01 | SCREW | | 1 |
| 81 | 531 00 82-20 | BOLT | | 1 |
| 82 | 575 36 18-01 | SCREW | | 1 |
| 83 | 519 65 34-55 | SCREW | | 1 |
| 84 | 573 94 31-01 | BOLT | | 3 |
| 85 | 573 94 25-01 | BOLT | LC170/750 SERIES | 2 |
| 85 | 519 65 34-12 | SCREW | GX/950 SERIES | 2 |
| 86 | 575 36 16-01 | SCREW | | 1 |
| 87 | 544 20 73-01 | SCREW | | 4 |
| 88 | 575 36 17-01 | SCREW | | 2 |
| 89 | 519 65 34-35 | SCREW | | 5 |
| 90 | 519 65 31-13 | SCREW | | 2 |
| 91 | 519 65 30-48 | SCREW | | 3 |
| 91 | 585 36 53-01 | SCREW | | 1 |
| 91 | 585 36 54-01 | SCREW | LC170 | 2 |
| 92 | 577 46 32-01 | BAG | GX | 1 |
| 93 | 519 65 34-47 | BLADE | GX | 1 |
| 94 | 519 65 34-48 | BLADE | | 1 |
| 200 | 577 49 04-01 | FLANGE | | 1 |
| 201 | 519 65 30-42 | HOUSING | | 1 |
| 202 | 519 65 30-41 | HOUSING | | 1 |
| 203 | 531 00 85-76 | RING | | 2 |
| 204 | 519 65 33-91 | PLUG | | 2 |
| 205 | 519 65 30-57 | PINION | | 1 |
| 206 | 519 65 30-07 | SPROCKET | | 1 |
| 207 | 575 36 23-01 | CHAIN | | 1 |
| 208 | 505 54 40-01 | BALL | | 1 |
| 209 | 519 65 30-53 | BEARING | | 2 |
| 210 | 531 00 85-46 | RING | | 1 |
| 211 | 585 36 55-01 | SPACER | | 1 |
| 212 | 732 26 16-01 | HEXAGON LOCKING NUT | | 1 |
| 213 | 501 96 38-01 | SCREW | | 1 |