

SB, Bagger top support bracket, M155-107HRB, M155-107TC, M185-107HRB, M185-107TC, M200-107HRB, M200-107TC, M220-107TC, 2014-01

Affected models

96051005100
96051006400, 96051006401
96051006500, 96051006501
96051005200
96051006600, 96051006601
96051006700, 96051006701
96051004000
96051005300
96051006800, 96051006801
96051007000, 96051007001

Affected serial number(s)

All 2012 and 2013 production.

Description

Some bagger top has been flanged out leading to grass leakage. This kit will solve the issue.

Parts information

New part no.	Part description	Old part no.
586 21 09-01	Kit. Bagger Top Support	-

Action

Normal warranty applies (replace when broken).

Warranty reporting

Component code: 633
Defect code: 11
Text: B1400001
Time units (6 minutes):
Affected market(s): All markets

Additional information

Instructions included below and with parts delivery.



TEX CRD GEN II BAGGER TOP SUPPORT BRACKET KIT

PARTS

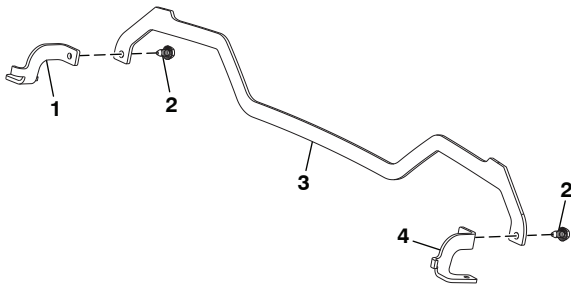

KEY NO.	QTY	PART NO.	DESCRIPTION
1	1	586 05 25-02	Bracket, Side Attachment LH
2	2	817 00 05-12	Screw 5/16
3	1	586 05 23-02	Bracket, Support, Top
4	1	586 05 24-02	Bracket, Side Attachment RH

NOTE: All component dimensions given in U.S. inches:
1 inch = 25.4 mm

INSTALLATION

These instructions will require the bagger assembly to be removed from tractor.

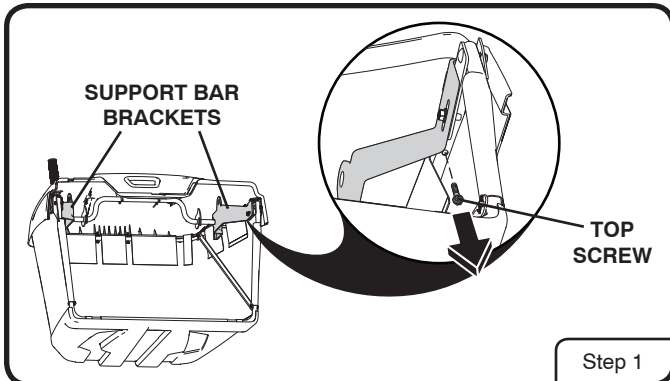

Step 1: Remove top screw from the left hand side of the front of the bagger assembly. Save top screw for future use.

NOTE: Top screw is located behind the support bar bracket.

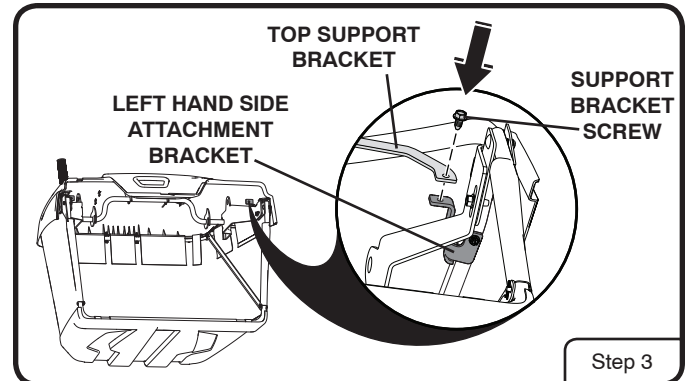

Step 3: Install and hand-tighten top support bracket into one of the side attachment brackets using one of the support bracket screws supplied with kit.

NOTE: Left hand side is shown for reference; it does not matter which side bracket is hand-tightened first.

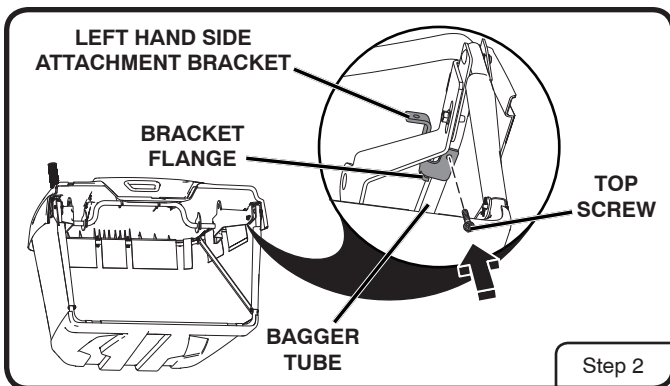

Step 2: Install side attachment bracket onto left hand side using top screw previously removed as shown in illustration. Ensure bracket flange is flush against bagger tube. Torque top screw to 48 - 72 In. Lbs. (5.4 - 8.1 Nm). Repeat steps 1 and 2 for the right hand side attachment bracket.

NOTE: Left and right hand side attachment brackets are marked "L" and "R" and are NOT interchangeable.

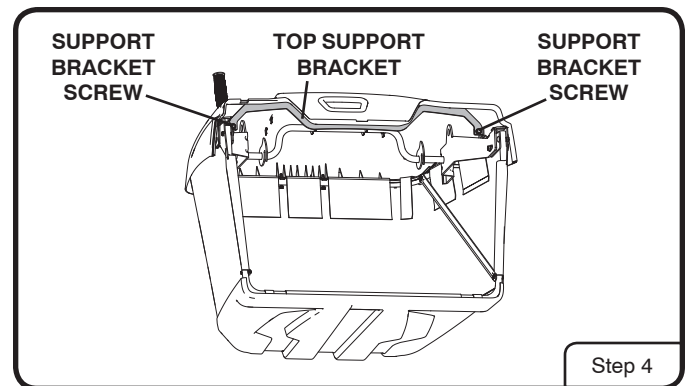

Step 4: Install the top support bracket into the other side attachment bracket using the remaining support bracket screw. Torque the second support bracket screw to 15 - 20 Ft. Lbs (20 - 27.1 Nm). Once completed, torque the first support bracket screw to 15 - 20 Ft. Lbs (20 - 27.1 Nm).